

SAPPHIRE® COMPACT Direct Low Pressure Automatic Fixed Fire Suppression System

Description

- Automatic and quick-acting pneumatically actuated fire suppression system (nominal charge of 15 bar (218 psi)) utilizing 3M™ Novec™ 1230 Fire Protection Fluid
- LPS 1666 Certified
- Protects enclosures with vents or forced air ventilation
- Requires no power supply for detection or actuation, remaining operational during power interruptions
- Can protect up to four enclosures with one system
- Highly reliable detection tube, unaffected by dirt, dust, debris, or oil

The schematic shows a typical installation. The design and installation should be completed in accordance with the ANSUL® SAPPHIRE® COMPACT manual (Part No. 449902, latest revision).

If multiple enclosures are being protected, the risk assessment must assume that a fire can occur in only one protected enclosure at one time.

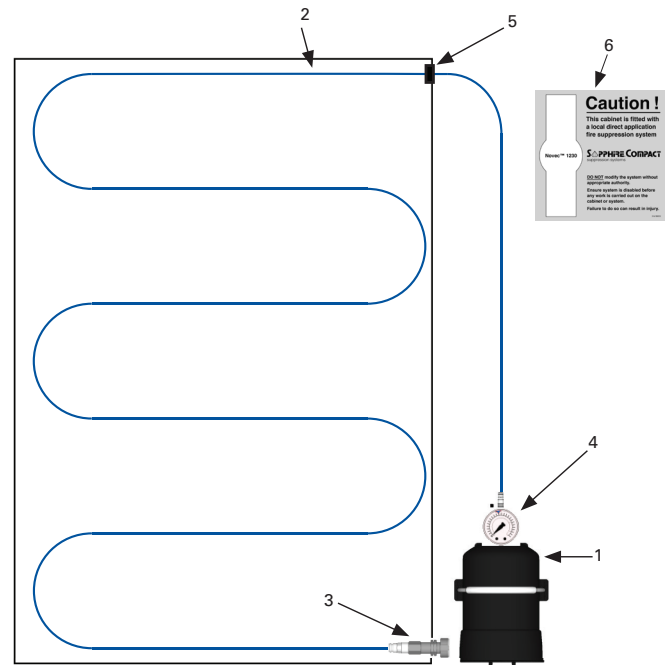

010769/E000953

Ordering Information

Item	Description	Part No.	Quantity (based on typical schematic above)
1	SAPPHIRE COMPACT container assembly with 2 kg (4.4 lb) Novec 1230 fluid	303150037	1
	SAPPHIRE COMPACT container assembly with 2.5 kg (5.5 lb) Novec 1230 fluid	303150038	
	SAPPHIRE COMPACT container assembly with 3 kg (6.6 lb) Novec 1230 fluid	303150039	
2	Detection tube (red)	304150013	10 m (32.8 ft)
3	End-of-line adaptor with pressure gauge	304150010	1
4	Pressure gauge with switch contact (standard) (Contacts closed at nominal charge pressure)	302150001	1
	Pressure gauge with switch contact (optional) (Contacts open at nominal charge pressure)	302150002	
5	Grommet - detection tube	304150003	1
6	Cabinet caution sign	314150013	1

Notes: 1. The pressure gauge with switch contact, normal duty container bracket, and cabinet caution sign are included within the container assembly part number.

2. LPS 1666 is limited to enclosures having a maximum volume of 2 m³ (70.6 ft³).

3. Part No. 304150013 quantity is dependent on the fire risk within the enclosure and design assessment by the system designer or installer.

4. The container design is in accordance with EN3.

Safety Data Sheets (SDS) are available at www.FireProductSDS.com.

Note: The converted metric values in this document are provided for dimensional reference only and do not reflect an actual measurement.

3M and Novec are trademarks of 3M Company.

ANSUL®, SAPPHIRE®, and the product names listed in this material are marks and/or registered marks. Unauthorized use is strictly prohibited.